

Standard Duty Rod U-Cup

Hardware Specifications

Type: 106 Series

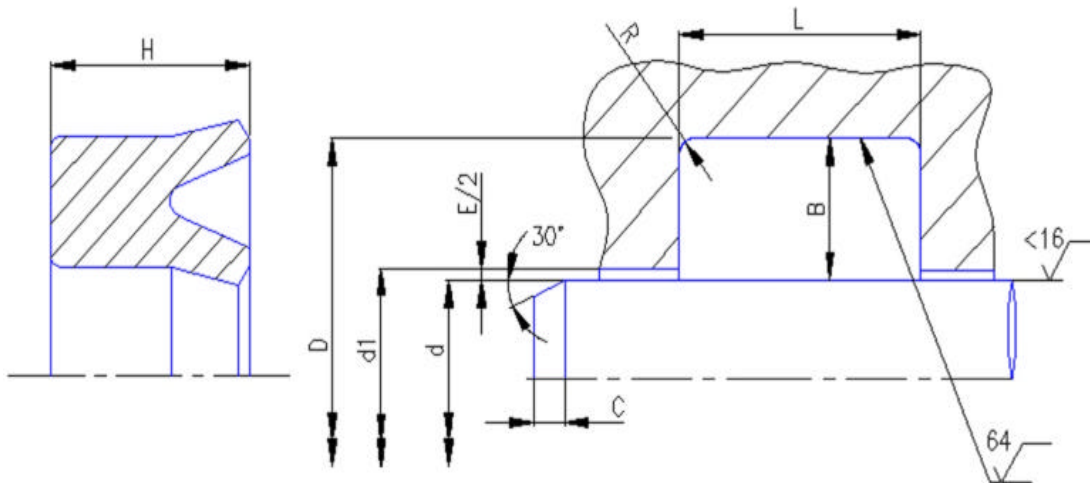

| | B | L | H | D | R typical | C |
|---------|-------|-------|-------|-----------|--------------|-------|
| series1 | 0.250 | 0.413 | 0.375 | d + 0.500 | 0.008 | 0.195 |
| series2 | 0.375 | 0.619 | 0.563 | d + 0.750 | 0.015 | 0.195 |
| series3 | 0.500 | 0.825 | 0.750 | d + 1.000 | 0.015 | 0.250 |
| series4 | 0.563 | 0.928 | 0.844 | d + 1.125 | 0.020 | 0.295 |
| series5 | 0.625 | 1.031 | 0.938 | d + 1.250 | 0.040 | 0.295 |
| series6 | 0.750 | 1.238 | 1.125 | d + 1.500 | 0.040 | 0.400 |
| series7 | 1.000 | 1.650 | 1.500 | d + 2.000 | 0.040 | 0.500 |

| Pressure | E |
|-----------|-------|
| <1500 psi | 0.020 |
| <3600 psi | 0.014 |
| <6000 psi | 0.009 |

Under certain conditions the extrusion gap can be increased, please consult our technical department.

Operating Conditions:

The operating conditions listed are based on our standard Polyurethane material. Other materials are available for special applications. In certain applications pressure rating can be increased with adjustment of extrusion gap E.

Material : P03/001 Standard

| | | |
|-----------------------------------|-------------------------|---------|
| Pressure | 4500psi (310 bar) | |
| Speed | 1.65 ft/sec (0.5 m/s) | |
| Media - Temp compatibility | Min (F) | Max (F) |
| Hydraulic oil | -38 | 250 |
| Water based Emulsions | 40 | 140 |
| Water Glycol | -38 | 140 |
| Water | 40 | 130 |
| Polyol Ester | -38 | 150 |